

## DIN 7 Dowel Pins

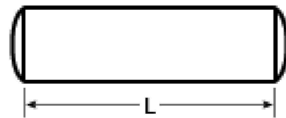

m6



h8

Length does not include the radiused or chamfered ends; the diameter of Tolerance Class m6 is oversized and has radiused ends, h8 is undersized and has chamfered ends with a 15° bevel at one end. Also known as Parallel Pins.

Nominal Diameter	End Length max.	Diameter Tolerance Zone	
		m6 max. / min.	h8 max. / min.
1	0.15	+0.008 / +0.002	0 / -0.014
1.2	0.18	+0.008 / +0.002	0 / -0.014
1.5	0.23	+0.008 / +0.002	0 / -0.014
2	0.3	+0.008 / +0.002	0 / -0.014
2.5	0.4	+0.008 / +0.002	0 / -0.014
3	0.45	+0.008 / +0.002	0 / -0.014
4	0.6	+0.012 / +0.004	0 / -0.018
5	0.75	+0.012 / +0.004	0 / -0.018
6	0.9	+0.012 / +0.004	0 / -0.018
8	1.2	+0.015 / +0.006	0 / -0.022
10	1.5	+0.015 / +0.006	0 / -0.022
12	1.8	+0.018 / +0.007	0 / -0.027
14	2	+0.018 / +0.007	0 / -0.027
16	2.5	+0.018 / +0.007	0 / -0.027
20	3	+0.021 / +0.008	0 / -0.033
25	4	+0.021 / +0.008	0 / -0.033

All dimensions are in millimeters (mm). A decimal point instead of a comma is used as the decimal marker.

For informational purposes only.